

GRI

Impeller with grinder system

All product images are indicative only



General characteristics

Impeller with grinder system	
motor power	1,7 kW
poles	2
discharge	GAS 2"-DN32 horizontal
free passage	-
max flow rate	6.8 l/s
max head	23.4 m

Electromechanical assembly

Electromechanical assembly in GJL-250 cast iron, for submerged operation. Seal set comprising 2 (two) silicon carbide mechanical seals, installed in series in inspectable oil sump. Ecological dry motor.

Applications

Can be used for lifting soiled wastewaters containing filaments or fibres, and heavy-duty applications with unstrained civil wastewaters in general.

Construction materials

Case	Cast iron EN-GJL 250
Impeller	Cast iron EN-GJL-250
Nuts and bolts	Stainless steel - Class A2-70
Standard gasket	Rubber - NBR
Cutter material	Chromium steel - X102 CrMo17 KU
Cutting disk material	Chromium steel - X102 CrMo17 KU
Shaft	Stainless steel - AISI 420
Paint type	Ecological bicomponent epoxy (medium thickness 80 µm)
Set of standard mechanical seals	Two silicon carbide mechanical seals (2SiC)

Operating limits

Maximum operating temperature	40 °C
PH of treated fluid	6 ÷ 14
Viscosity of treated fluid	1 mm ² /s
Maximum immersion depth	20 m
Density of treated fluid	1 Kg/dm ³
Maximum acoustic pressure	70 dB
max starts per hour	30

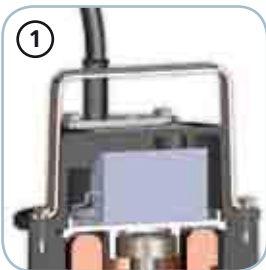
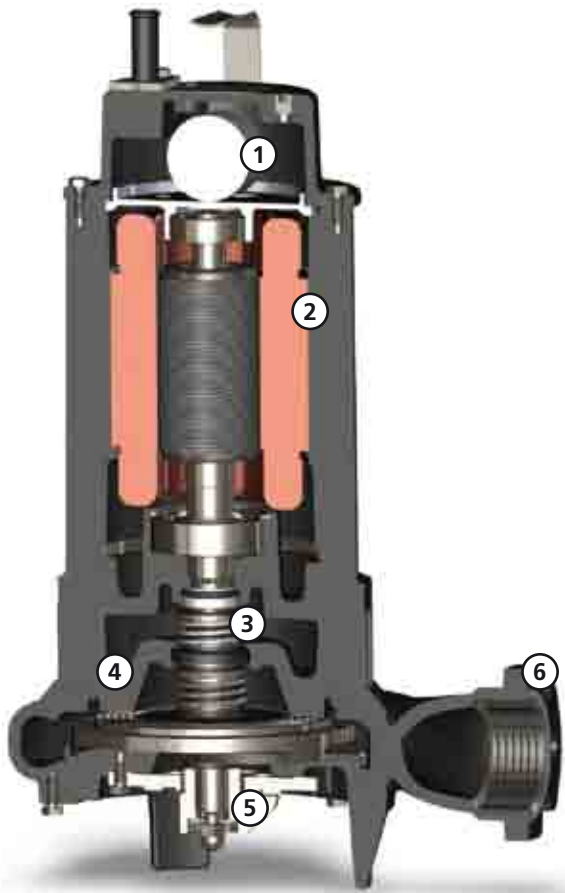

①

Capacitor/relay

Single-phase models with internal capacitor and control cabinet with circuit breaker capacitor and overload protection. Three-phase models with motor protection relay.

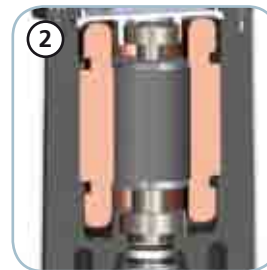

②

Structure and motor

Constructed in GJL-250 cast iron. Ecological dry motor with thermal protections.



③

Mechanical seals

Two mechanical seals in silicon carbide (2SiC).



④

Oil sump

Large oil sump to guarantee longer mechanical seal lifetime.



⑤

Grinder system

Grinder system comprising a revolving cutter and a plate with holes with sharpened edges that fine-chops filaments, preventing fouling of the impeller.

Up to 69.000 cuts per minute

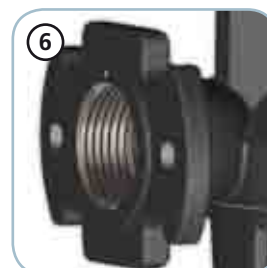

⑥

Discharge

Threaded, flanged discharge for the maximum ease of installation.

GRI

Models with horizontal GAS 2" threaded - DN32 PN6 flanged discharge - 2 poles

Performances

<i>l/s</i>	0	1	2	3	4	5	6
<i>l/min</i>	0	60	120	180	240	300	360
<i>m³/h</i>	0	3.6	7.2	10.8	14.4	18.0	21.6

① GRI 200/2/G50H A0CM(T)/50	23.4	22.4	20.7	18.2	14.9	10.8	5.8
-----------------------------	------	------	------	------	------	------	-----

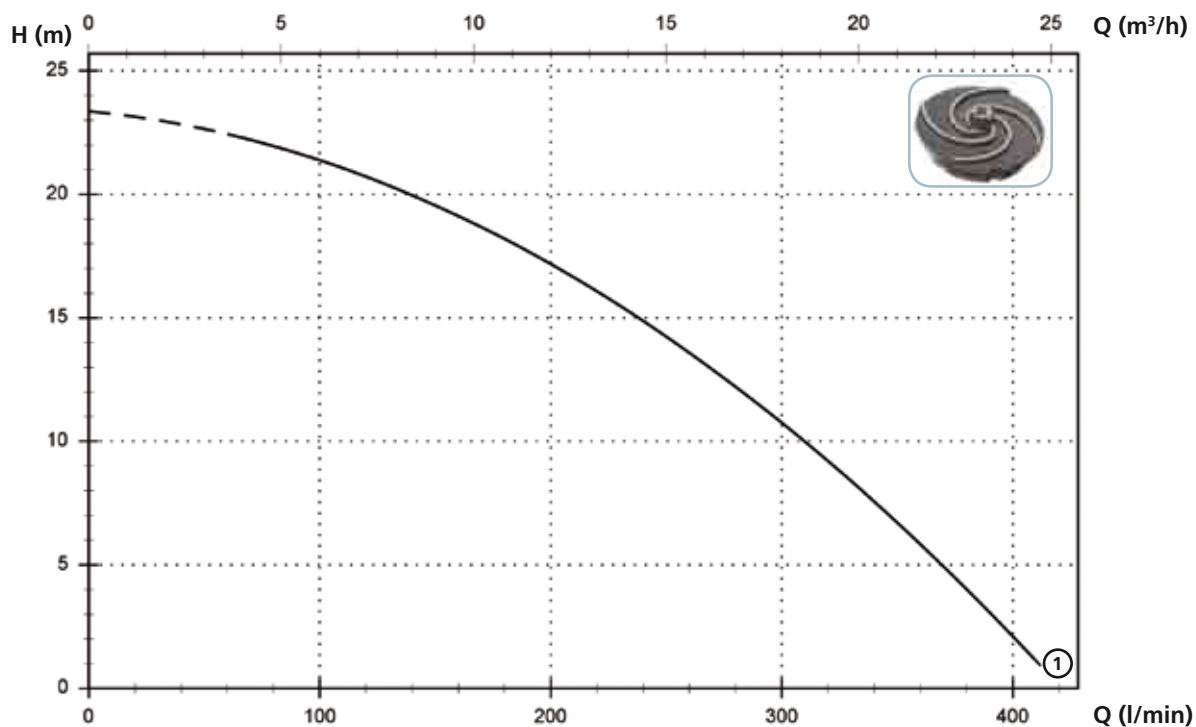

Technical data

	V	Phases	P1 (kW)	P2 (kW)	A	Rpm	Start	Ø	Free passage
① GRI 200/2/G50H A0CM/50	230	1	-	1.7	10.6	2900	Dir	G 2"-DN32 PN6	-
① GRI 200/2/G50H A0CT/50	400	3	-	1.7	3.8	2900	Dir	G 2"-DN32 PN6	-

Versions available

(Key to versions on page 16)

	Electrical variants										Cooling				Mechanical seals					
	N A E	T	T C	T C D	T C D T	T C D G T	T C G	T C S T	T C S G T	T S	T R	T R G	N	CC CCE	FT	C G F T	2SIC	SICM	SICAL	2SICAL
GRI 200/2/G50H A0CM/50					●	●						●					●			
GRI 200/2/G50H A0CT/50										●	●	●					●			

Overall dimensions and weights

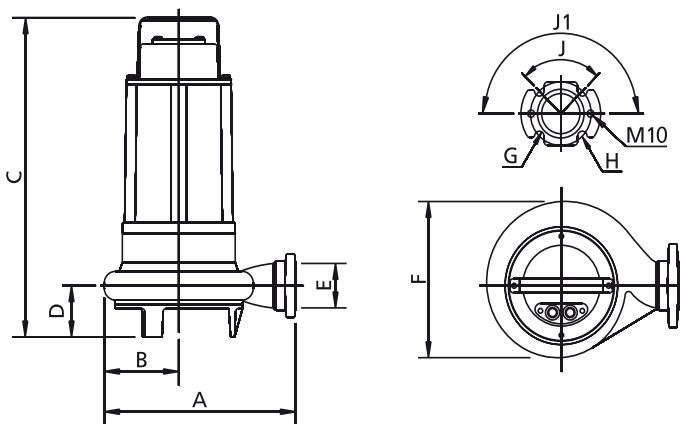

	A	B	C	D	E	F	G	H	J	J1	kg
GRI 200/2/G50H A0CM(T)/50	285	110	450	75	G 2"	220	14	90	90°	180°	32

Dimensions in mm

All weights and dimensions are indicative only

Packaging dimension

	A	B	C
GRI 200/2/G50H A0CM(T)/50	580	310	310

Dimension in mm

All weights and dimensions are indicative only

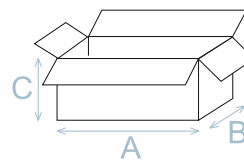

Installations available

