

SMF

Single-channel closed impeller



All product images are indicative only



General characteristics

| Single-channel closed impeller | |
|--------------------------------|------------------------|
| motor power | 0,74 kW ÷ 1,5 kW |
| poles | 2 |
| discharge | GAS 2"-DN80 horizontal |
| free passage | 50 mm |
| max flow rate | 14 l/s |
| max head | 16.1 m |

Electromechanical assembly

Electromechanical assembly in GJL-250 cast iron, for submerged operation. Seal set comprising 2 (two) silicon carbide mechanical seals assembled opposing in inspectable oil sump. Ecological dry motor. Series with explosion-proof ATEX certification.

Applications

Designed specifically for operation where there are traces of flammable liquids or in potentially explosive atmospheres, the SMF can be used with soiled liquids containing traces of flammable substances, and in gassy environments.

Construction materials

| | |
|----------------------------------|--|
| Case | Cast iron EN-GJL 250 |
| Impeller | Cast iron EN-GJL-250 |
| Nuts and bolts | Stainless steel - Class A2-70 |
| Standard gasket | Rubber - NBR - VITON |
| Shaft | Stainless steel - AISI 420 |
| Paint type | Ecological bicomponent epoxy (medium thickness 150 µm) |
| Set of standard mechanical seals | Two silicon carbide mechanical seals (2SiC) |

Operating limits

| | |
|-------------------------------|----------------------|
| Maximum operating temperature | 40 °C |
| PH of treated fluid | 6 ÷ 14 |
| Viscosity of treated fluid | 1 mm ² /s |
| Maximum immersion depth | 20 m |
| Density of treated fluid | 1 Kg/dm ³ |
| Maximum acoustic pressure | 70 dB |
| max starts per hour | 30 |

SMF



CE 0496  II 2GD Ex db k c IIB T4 Ex tb IIIC T135°C IP68

Models with ATEX certification, suitable for installation in the presence of potentially explosive gases, powders and liquids



Handle/Cable gland

Cast iron lifting and carrying handle. The GAS thread ring-nut can be removed to fix a rigid or flexible duct to the cable gland to protect the power supply cable.

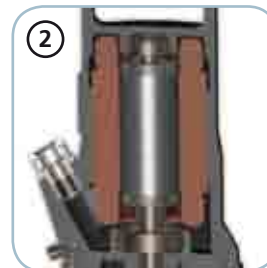

Motor

Ecological dry motor with thermal protections.



Mechanical seals

Two silicon carbide (SiC) mechanical seals in oil sump.



Oil sump

Large oil sump to guarantee longer mechanical seal lifetime.



Drive shaft

Impeller connected to the drive shaft by means of tapered coupling.



Discharge and foot

Threaded, flanged discharge for the maximum ease of installation. Cast iron foot.

SMF

Models with horizontal GAS 2" threaded - DN50 PN10 flanged discharge - 2 poles

Performances

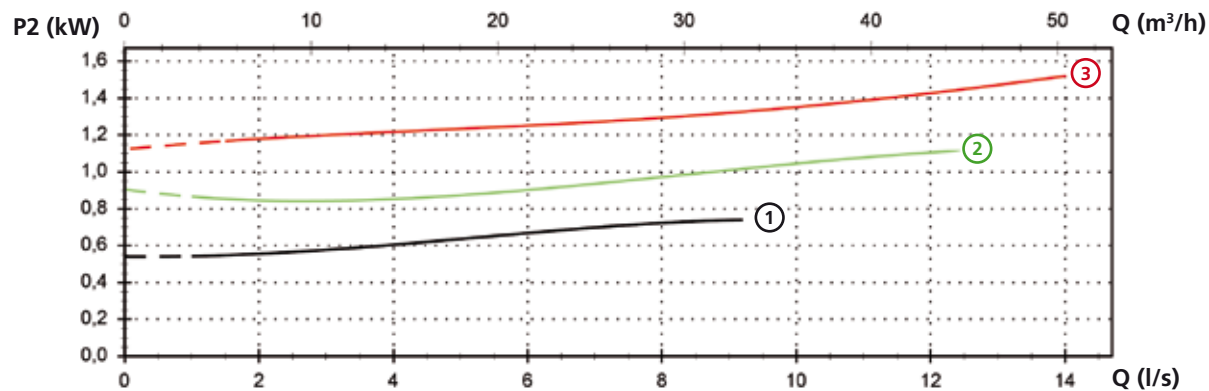
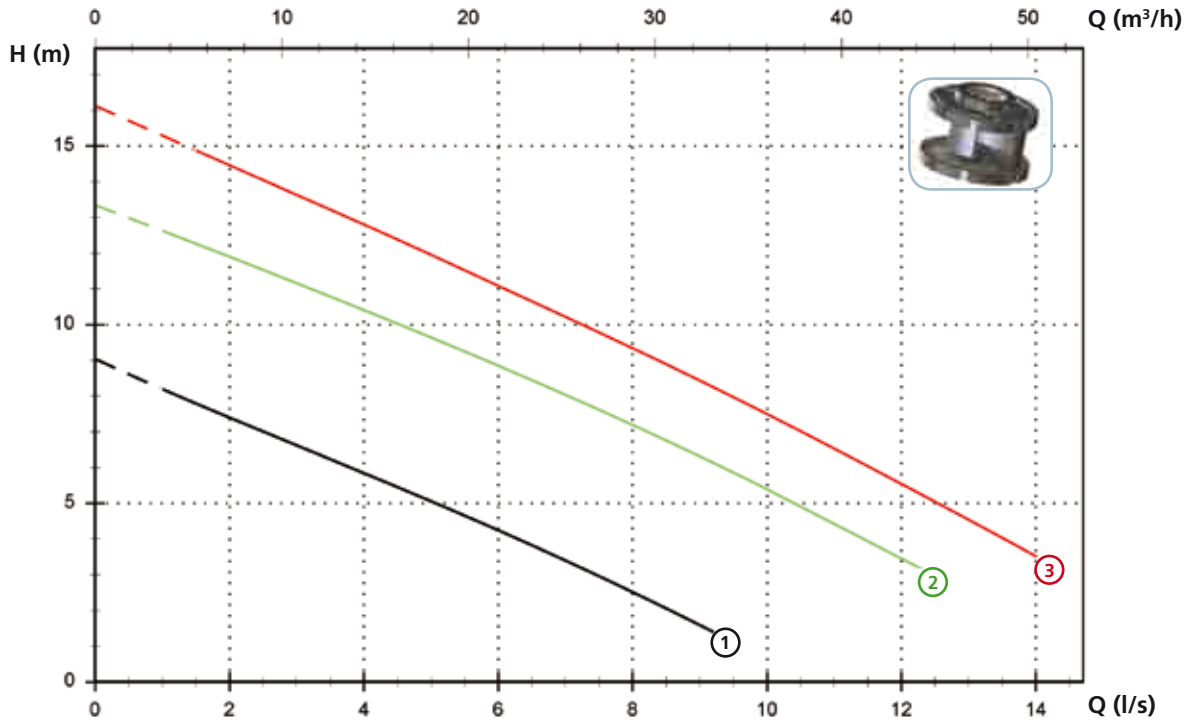

Technical data

| | V | Phases | P1 (kW) | P2 (kW) | A | Rpm | Start | Ø | Free passage |
|--------------------------|-----|--------|---------|---------|-----|------|-------|----------------|--------------|
| ① SMF 100/2/G50H A1CM/50 | 230 | 1 | 1.0 | 0.74 | 4.9 | 2900 | Dir | G 2"-DN80 PN10 | 50 mm |
| ② SMF 150/2/G50H A1CM/50 | 230 | 1 | 1.6 | 1.1 | 7.2 | 2900 | Dir | G 2"-DN80 PN10 | 50 mm |
| ③ SMF 200/2/G50H A1CM/50 | 230 | 1 | 2.2 | 1.5 | 9.8 | 2900 | Dir | G 2"-DN80 PN10 | 50 mm |

| | V | Phases | P1 (kW) | P2 (kW) | A | Rpm | Start | Ø | Free passage |
|--------------------------|-----|--------|---------|---------|-----|------|-------|----------------|--------------|
| ① SMF 100/2/G50H A1CT/50 | 400 | 3 | 1.1 | 0.74 | 1.9 | 2900 | Dir | G 2"-DN80 PN10 | 50 mm |
| ② SMF 150/2/G50H A1CT/50 | 400 | 3 | 1.7 | 1.1 | 2.9 | 2900 | Dir | G 2"-DN80 PN10 | 50 mm |
| ③ SMF 200/2/G50H A1CT/50 | 400 | 3 | 2.1 | 1.5 | 3.7 | 2900 | Dir | G 2"-DN80 PN10 | 50 mm |

SMF

Versions available

(Key to versions on page 16)

| | Electrical variants | | | | | | | | | | | Cooling | | | | Mechanical seals | | | | |
|------------------------|---------------------|---|--------|-------------|------------------|-----------------------|-------------|------------------|-----------------------|--------|--------|-------------|---|-----------|----|------------------|------|------|-------|--------|
| | N A E | T | T C | T C D | T C D T | T C D G T | T C G | T C S T | T C S G T | T S | T R | T R G | N | CC CCE | FT | C G F T | 2SIC | SICM | SICAL | 2SICAL |
| SMF 100/2/G50H A1CM/50 | | | ● | | | | | | | | | | ● | | | | ● | | | |
| SMF 150/2/G50H A1CM/50 | | | ● | | | | | | | | | | ● | | | | ● | | | |
| SMF 200/2/G50H A1CM/50 | | | ● | | | | | | | | | | ● | | | | ● | | | |
| SMF 100/2/G50H A1CT/50 | | ● | | | | | | | | | | | ● | | | | ● | | | |
| SMF 150/2/G50H A1CT/50 | | ● | | | | | | | | | | | ● | | | | ● | | | |
| SMF 200/2/G50H A1CT/50 | | ● | | | | | | | | | | | ● | | | | ● | | | |

NOTE FOR SINGLE PHASE PUMPS: thermal protections into the winding have to be connected to the electrical panel. Capacitor supplied but not connected to the pump cable. The use of an electrical panel as circuit breaker housing is mandatory. For installation please see use and maintenance instructions booklet.

Overall dimensions and weights

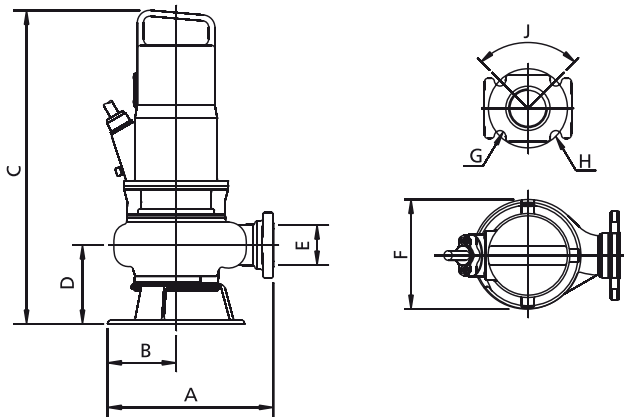

| | A | B | C | D | E | F | G | H | J | kg |
|---------------------------|-----|-----|-----|-----|------|-----|----|-----|-----|----|
| SMF 100/2/G50H A1CM(T)/50 | 255 | 100 | 505 | 130 | G 2" | 205 | 18 | 160 | 90° | 34 |
| SMF 150/2/G50H A1CM(T)/50 | 255 | 100 | 505 | 130 | G 2" | 205 | 18 | 160 | 90° | 35 |
| SMF 200/2/G50H A1CM(T)/50 | 255 | 100 | 505 | 130 | G 2" | 205 | 18 | 160 | 90° | 36 |

Dimensions in mm

All weights and dimensions are indicative only

Packaging dimension

| | A | B | C |
|---------------------------|-----|-----|-----|
| SMF 100/2/G50H A1CM(T)/50 | 580 | 310 | 310 |
| SMF 150/2/G50H A1CM(T)/50 | 580 | 310 | 310 |
| SMF 200/2/G50H A1CM(T)/50 | 580 | 310 | 310 |

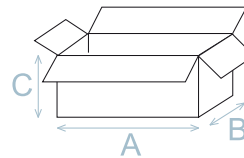

Dimension in mm

All weights and dimensions are indicative only

Installations available

